

How to connect to the eduroam Wi-Fi service at another location using Windows 10

These instructions will help University of Otago staff and students connect to the eduroam wireless (Wi-Fi) service at participating locations. The default eduroam WLAN settings for your laptop are:

Eduroam Wi-Fi Security Configuration	
SSID	eduroam
Security	WPA2-Enterprise (802.1X/EAP)
Authentication Method	PEAP-MSCHAPv2
Encryption Type	AES-CCMP
Login User Account	<university_username>@otago.ac.nz
Validate Server Certificate	AddTrust External CA Root OR AusCERTServerCA.crt

The Trusted Root CA certificate can be downloaded here if required:

<https://www.quovadisglobal.com/download-roots-crl/>

Select: QuoVadis Root CA2
SHA1 - RSA - 4096
Download as DER

QuoVadis Root CA2 SHA1 - RSA - 4096	Valid until: 24/Nov/2031 Serial: 05 09 CRL: http://crl.quovadisglobal.com/qvrca2.crl Download as DER - Download as PEM
---	--

Setting up an eduroam wireless connection at another location using Windows 10

This section provides step-by-step instructions to configure your eduroam WLAN settings.

1. Once you are at the eduroam-participating location, click on your **Network Connections** icon (wireless bars) in the system tray, and click on **eduroam** from the available wireless networks, then click **Connect**

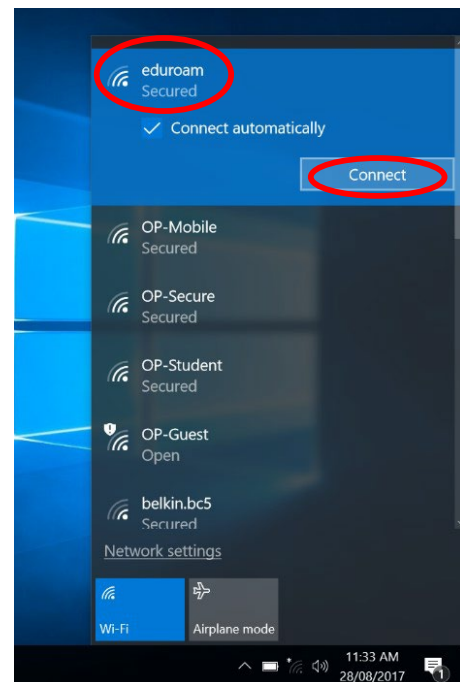

2. You will be prompted to enter your University of Otago username (in the format <username>@otago.ac.nz) and password. Click OK.

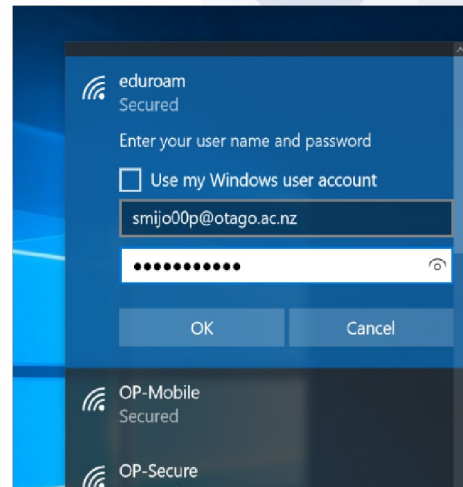

3. You will be prompted to accept the credentials (security certificate) from the authentication server. Click on the **Connect** button.

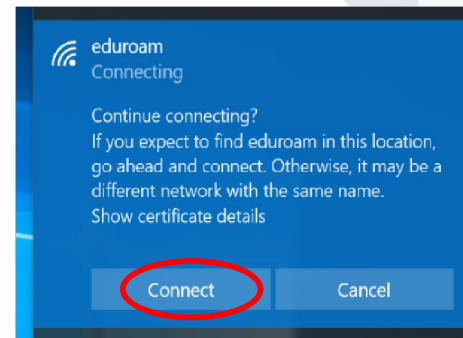

4. Open your web browser and go to <http://www.otago.ac.nz> to confirm that you are connected to the eduroam network. If this step fails, please reconnect to the eduroam wireless network by disabling then reenabling your Wi-Fi. You will be asked for your University of Otago login credentials again.

Please contact AskOtago if you need any help with setting up Windows 10 for eduroam: phone 64 3 479 7000 or 0800 80 80 98 or email askotago.it@otago.ac.nz